



ETH Electric Horn

Protection mode:

Type of protection: II 2 GD EEx d IIB
 Class of temperature: T6-T5
 Protection degree: IP 55



Description:

The ETH acoustic device consists of a body and a cover in aluminium alloy connected by socket head screws. Working by vibrating membrane with diffuser cone.

For acoustic warning of alarms, failures, and so on.

Technical data:

Materials:

Body and cover: aluminium alloy.
 Acoustic horn: aluminium alloy.
 Cables entry:
 Entry . 3/4 h UNI 6125 (ISO 7/1).
 Inhibiting treatments:
 Epoxy painting RAL 7000.

Technical drawing:

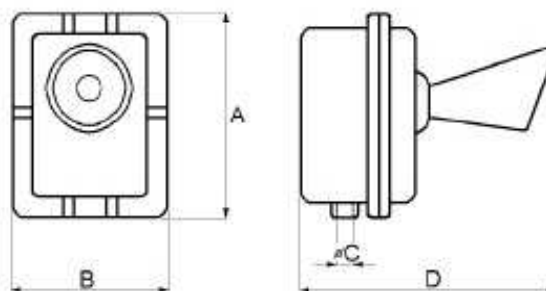

Type	Dimensions (mm)				Rated Voltage (V)	Power (VA)	Sound intensity dB (3m)
	A	B	∅ C	D			
ETH 12V	113	146	3/4"	225	12 Vac	50	101
ETH 24V	113	146	3/4"	225	24 Vac	75	103
ETH 48V	113	146	3/4"	225	48 Vac	80	103
ETH 110V	113	146	3/4"	225	110 Vac	50	103
ETH 220V	113	146	3/4"	225	220 Vac	50	104